

# DALLE SUPPORT DE CONTAINER 1,40 x 1,00 x 0,05 m AVEC DOUILLES M12

A-A ( 1 : 8 )

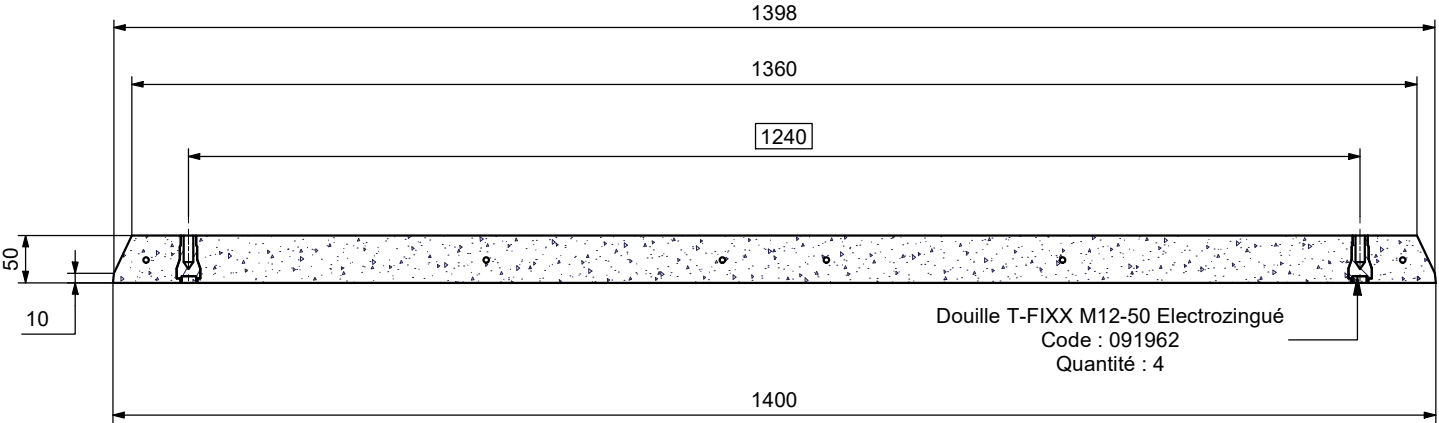

B-B ( 1 : 8 )

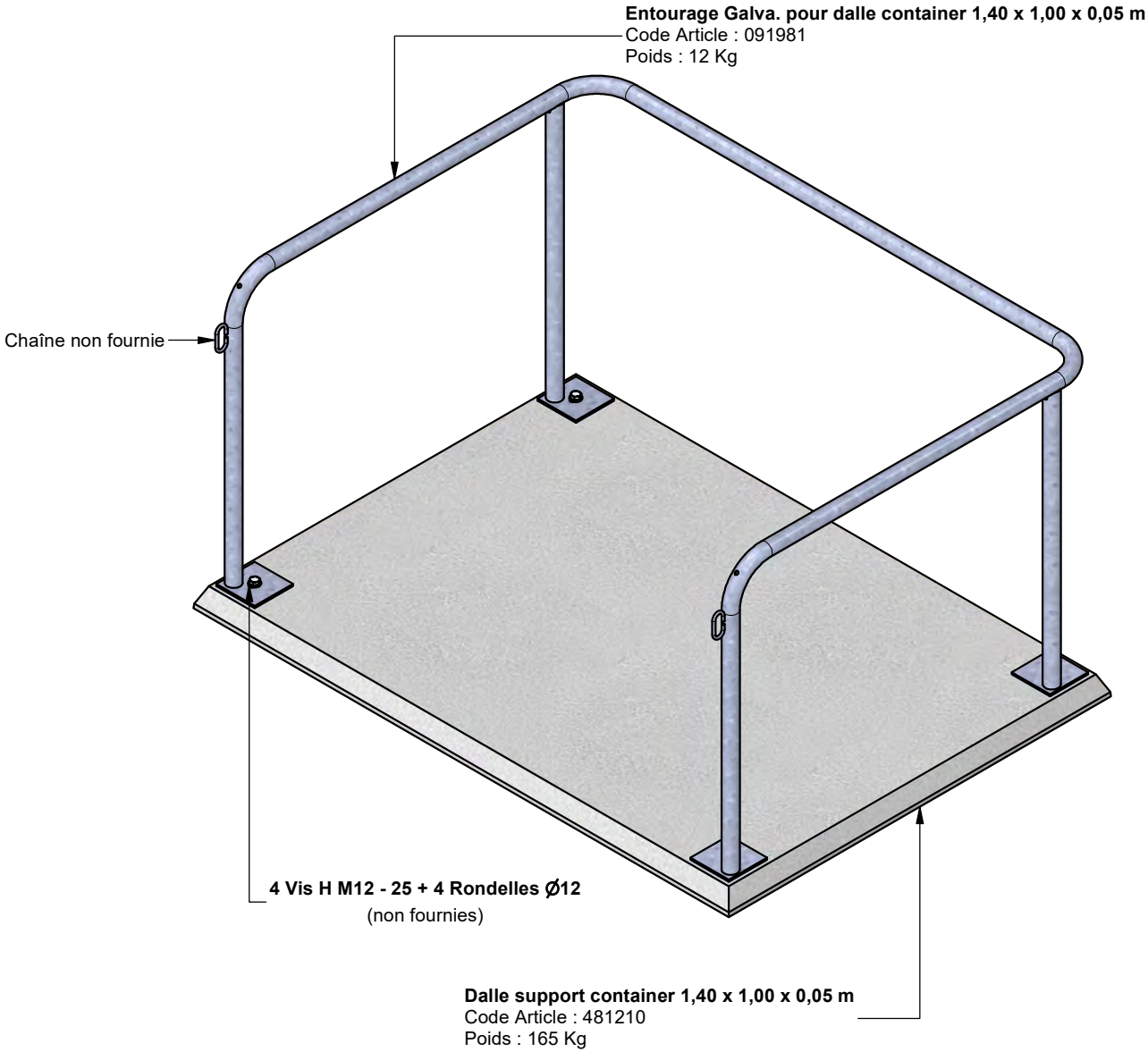
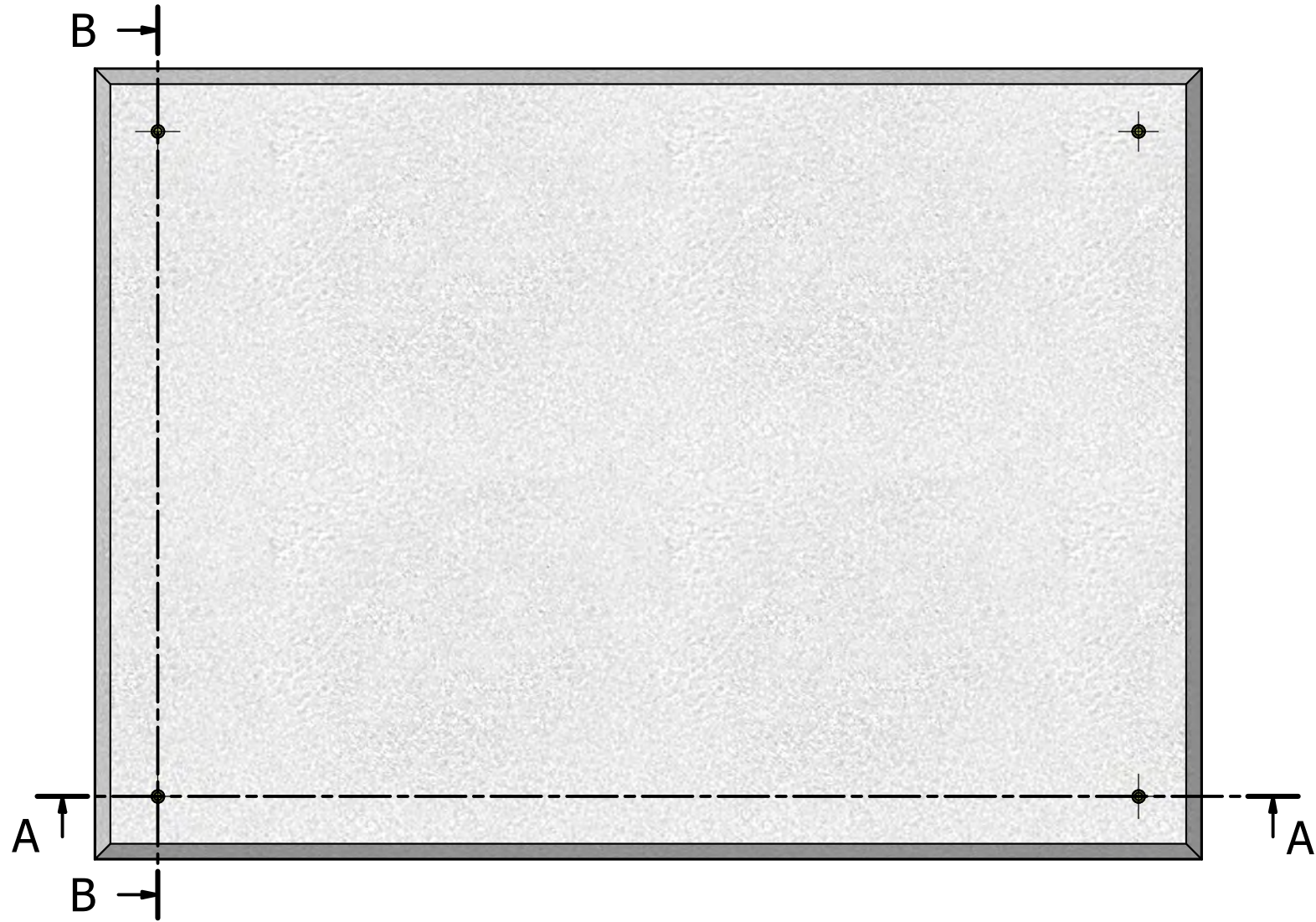
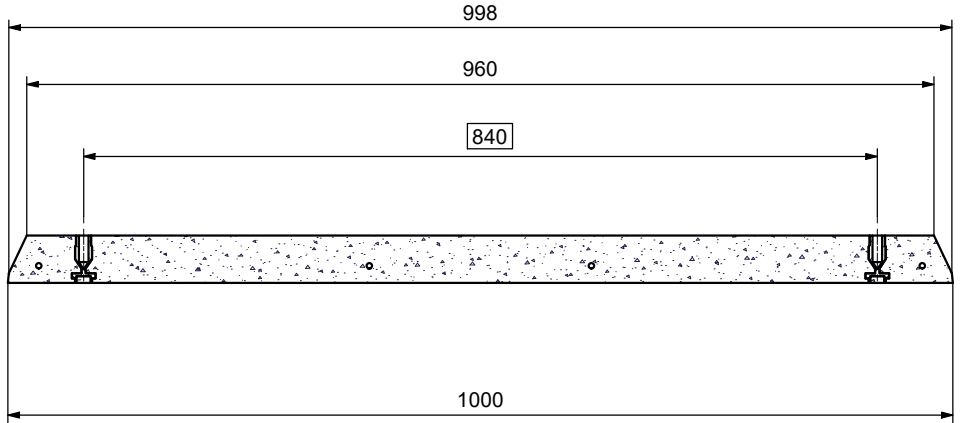

**ENTOURAGE GALVA POUR DALLE CONTAINER 1,40 x 1,00 x 0,05 m**

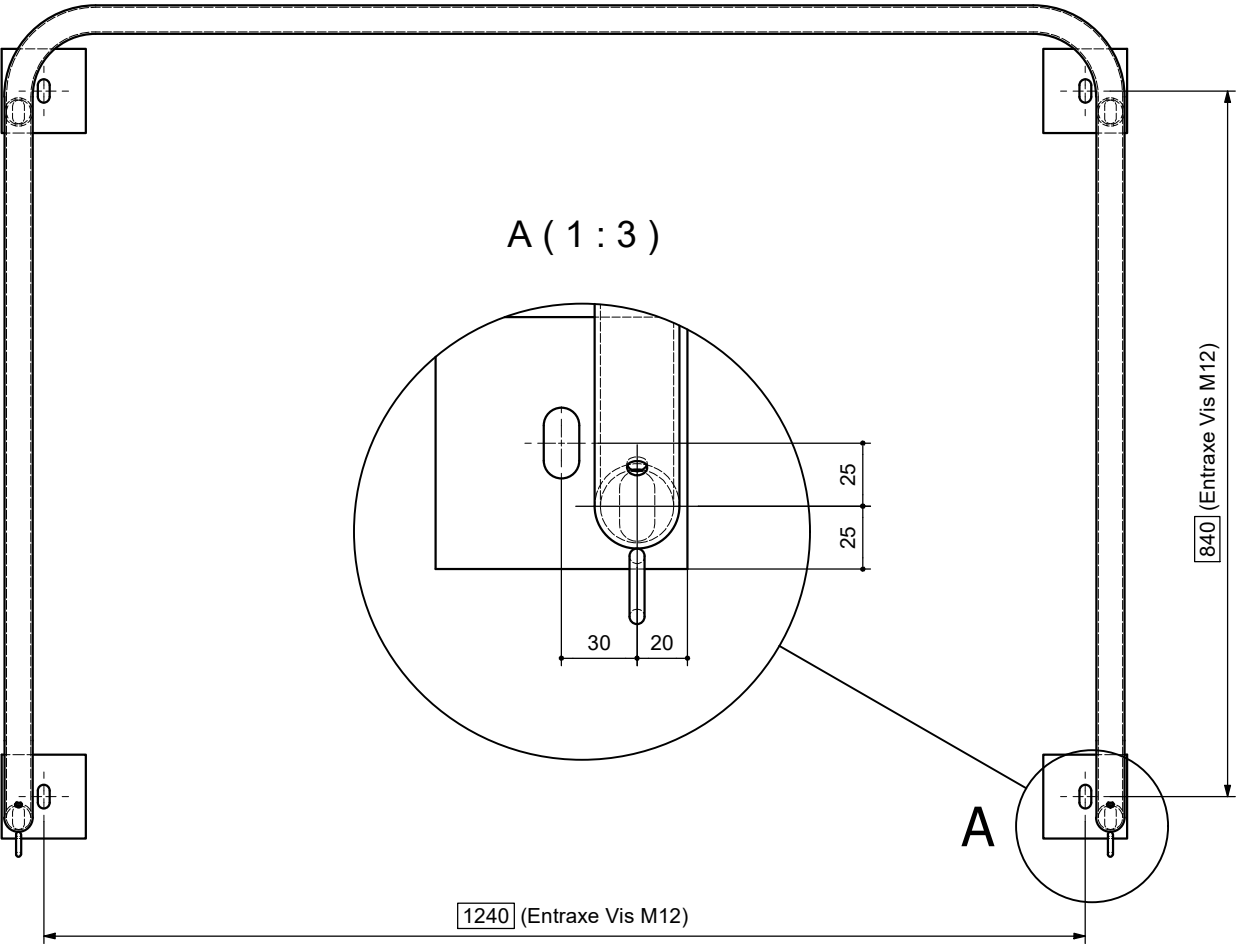
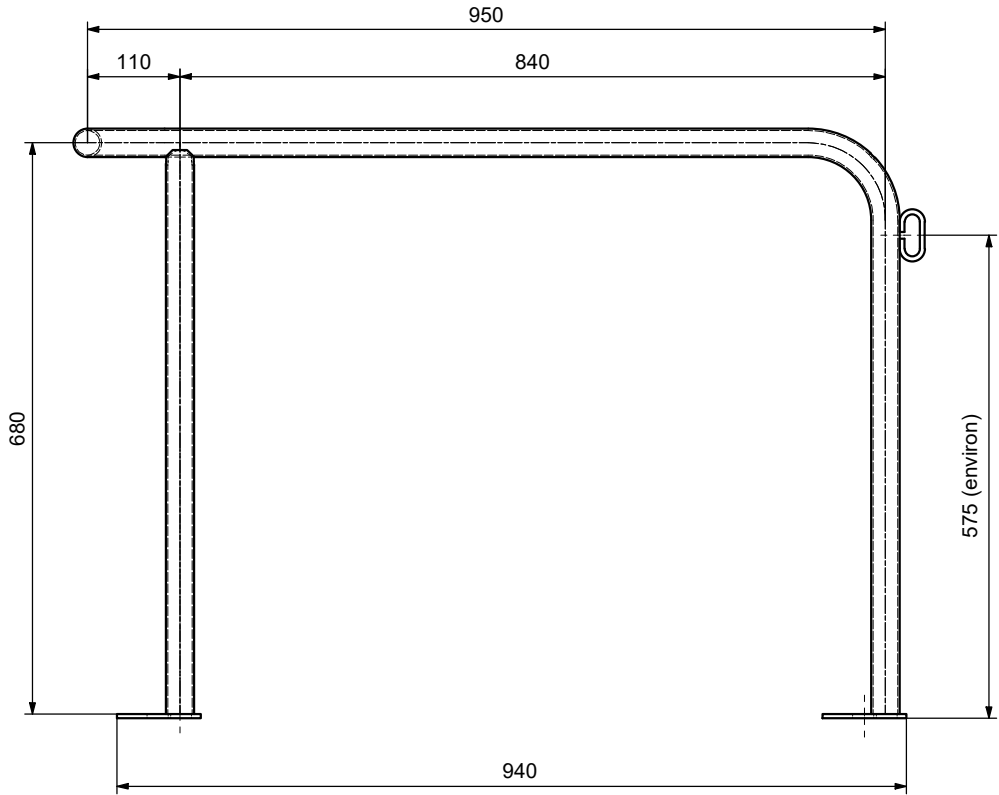
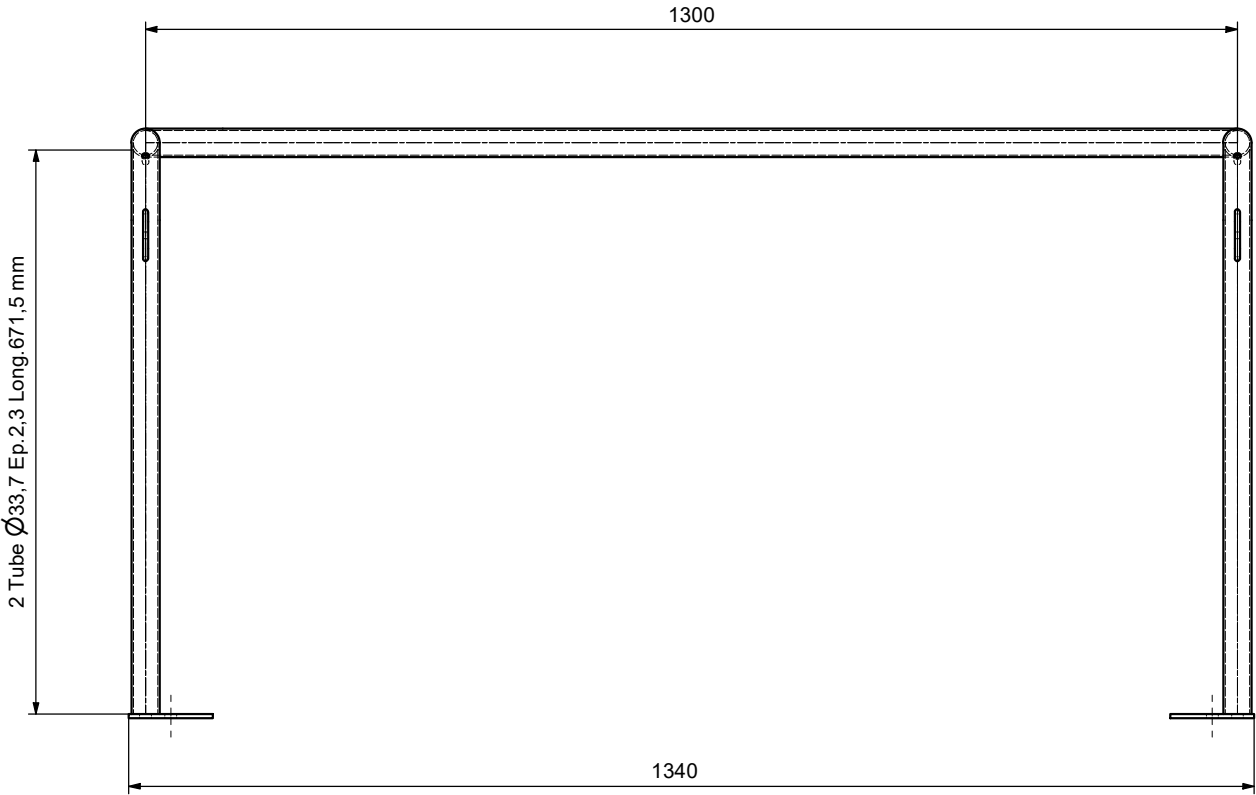

Détail d'une platine Ep.5 mm  
 (Quantité : 4)

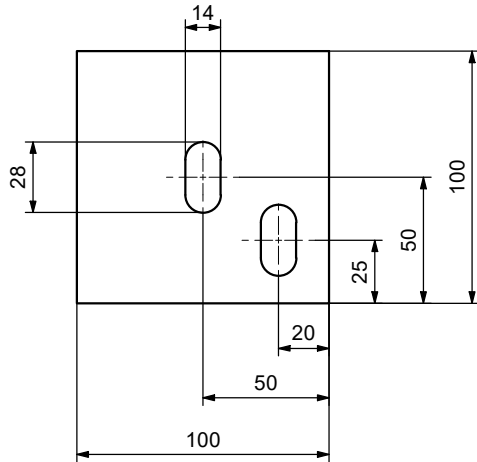

Détail d'un anneau pour  
 fixation chaîne (Quantité : 2)

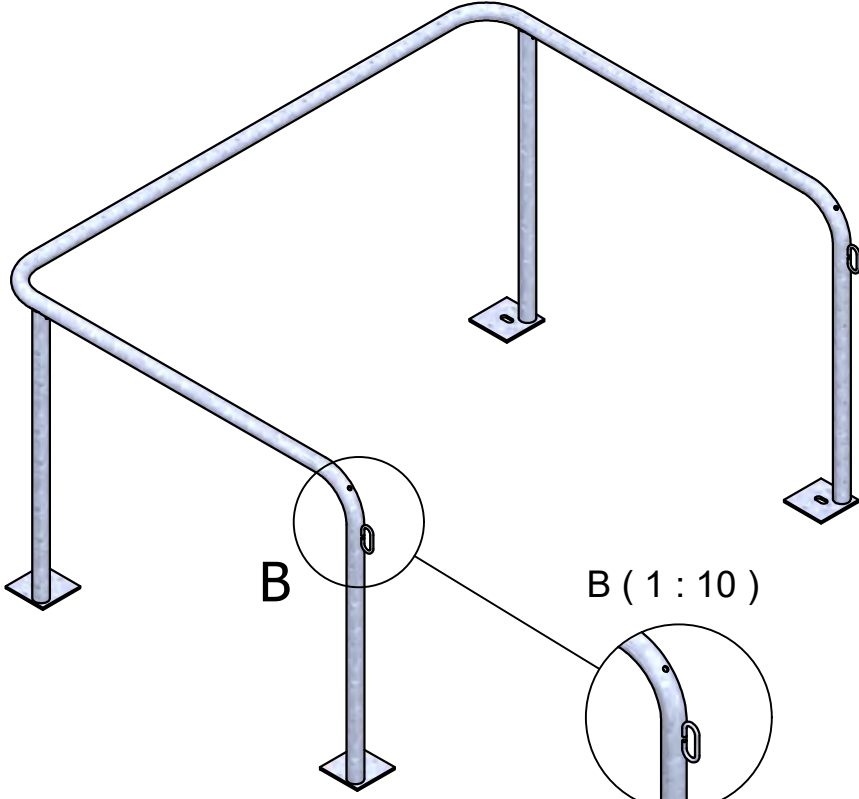
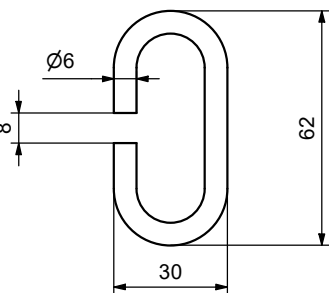

**THEBAULT**  
 L'EXPÉRIENCE CONSTRUCTIVE

Code Article : 091981    Poids : 11,7    Kg

Version1 - Le 30/03/2016